

MATO Connect Bridge Beam



- Lightest beam on the market with 11.38 kg/m for a height of 280 mm
- Best moment of inertia and section modulus
- Maximum safety during assembly
- High efficiency thanks to shorter assembly and disassembly times
- Extremely practical
- Perfect connection to the modular scaffolding system



MATO Connect **Bridge Beam**

For greater safety and higher speed in bridge construction.

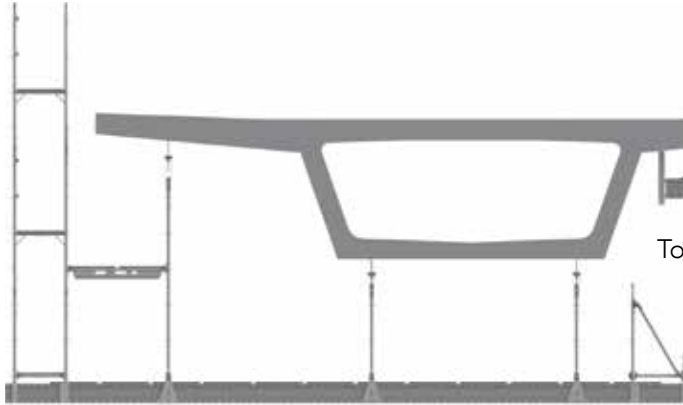

Tobler bridge beam LB-150650

Tobler bridge beam LB-150250

Application example 1

5
Light Bridge Beams
from Tobler have
the same weight as
4
conventional
beams



MATO Connect Bridge Beam

The lightest beam on the market.

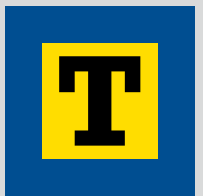

Lightweight bridge beam

- Made of aluminium
- With special lightweight profile

| Article no. | Length | Height | Weight |
|-------------|--------|--------|--------|
| LB-150150 | 150cm | 28cm | 12,8kg |
| LB-150250 | 250cm | 28cm | 21,7kg |
| LB-150350 | 350cm | 28cm | 30,6kg |
| LB-150450 | 450cm | 28cm | 39,5kg |
| LB-150550 | 550cm | 28cm | 48,3kg |
| LB-150650 | 650cm | 28cm | 57,2kg |
| LB-150750 | 750cm | 28cm | 66,0kg |

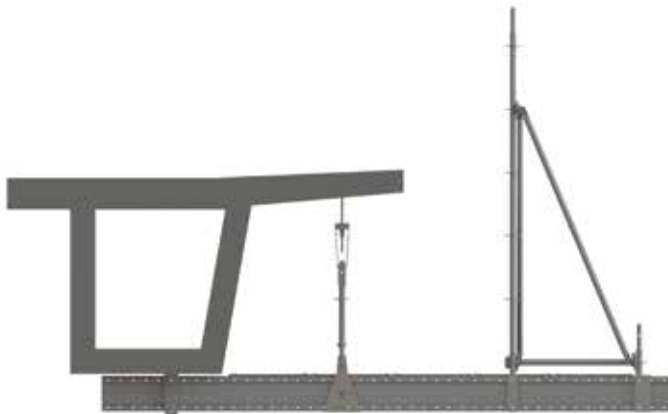
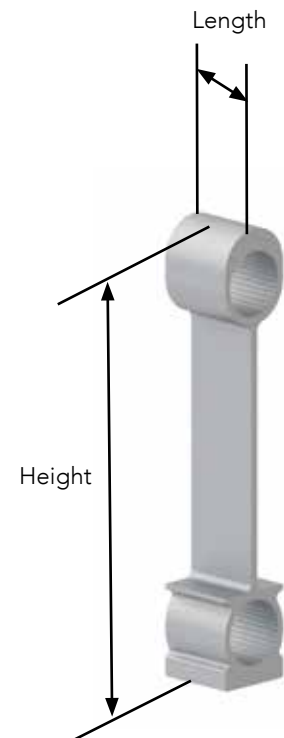

Tobler bridge beam LB-150250

Application example 2



MATO Connect **Bridge Beam**

Connectors.

Suspension shoe

- Made of steel

| Article no. | Width | Height | Weight |
|-------------|-------|--------|--------|
| LB-200030 | 30 cm | 63 cm | 9,5 kg |



LB-200030

Application example



Shaft connection

- Made of steel

| Article no. | Width | Height | Weight |
|-------------|-------|--------|--------|
| LB-200040 | 9 cm | 70 cm | 4,9 kg |



LB-200040

Application example



Shaft connection, wide

- Made of steel

| Article no. | Width | Height | Weight |
|-------------|-------|--------|--------|
| LB-200041 | 13 cm | 70 cm | 6,2 kg |



LB-200041



LB-200044

Shaft connection without plate

- Made of steel

| Article no. | Width | Height | Weight |
|-------------|-------|--------|--------|
| LB-200044 | 9 cm | 55 cm | 3,4 kg |

Bolt

- Made of steel

| Article no. | Description | Weight |
|-------------|--------------|---------|
| Z-834002 | Ø 12 × 85 mm | 0,08 kg |



Z-834002

MATO Connect Bridge Beam

Connectors.

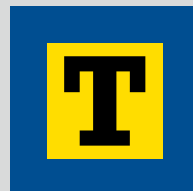

Ceiling connection

- Made of steel

| Article no. | Base plate | Height | Weight |
|-------------|------------|--------|--------|
| LB-200010 | 25 × 12 cm | 33 cm | 5,4 kg |

Ceiling connection, heavy

- Made of steel

| Article no. | Base plate | Height | Weight |
|-------------|------------|--------|---------|
| LB-200015 | 30 × 30 cm | 34 cm | 11,5 kg |

Wall connection

- Made of steel

| Article no. | Base plate | Height | Weight |
|-------------|------------|--------|---------|
| LB-200020 | 20 × 20 cm | 9 cm | 10,0 kg |

Connecting tube

- Made of steel
- Ø 38 × 8 mm

| Article no. | Length | Weight |
|-------------|--------|--------|
| LB-200005 | 60 cm | 3,4 kg |

Wooden ledger

| Article no. | Length | Weight |
|-------------|--------|---------|
| LB-510100 | 100 cm | 5,2 kg |
| LB-510150 | 150 cm | 6,9 kg |
| LB-510200 | 200 cm | 8,6 kg |
| LB-510250 | 250 cm | 10,3 kg |
| LB-510300 | 300 cm | 12,0 kg |

Wind protection for bridge beam

- Made of steel

| Article no. | Base plate | Height | Weight |
|-------------|------------|--------|---------|
| LB-276015 | 16 × 6 cm | 8,9 cm | 0,95 kg |



LB-200010



LB-200015



LB-200020



LB-200005

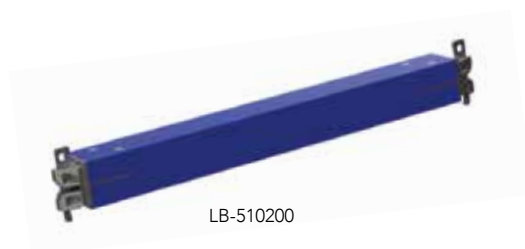

LB-510200



LB-276015

MATO Connect **Bridge Beam**

Connectors.

Swiss Gewi suspension, small

- Made of steel

| Article no. | Height | Weight |
|-------------|--------|--------|
| LB-200045 | 36 cm | 3,1 kg |



LB-200045

Swiss Gewi suspension, large

- Made of steel

| Article no. | Height | Weight |
|-------------|--------|--------|
| LB-200050 | 50 cm | 3,7 kg |



LB-200050

Pressure plate

- Made of steel
- Base plate 18 × 10 cm

| Article no. | Length | Weight |
|-------------|--------|---------|
| LB-220030 | 30 cm | 4,3 kg |
| LB-220050 | 50 cm | 6,6 kg |
| LB-220075 | 75 cm | 8,8 kg |
| LB-220100 | 100 cm | 11,0 kg |
| LB-220125 | 125 cm | 14,0 kg |



LB-220050

LB beam connection to pressure plate

- Made of steel

| Article no. | Length | Height | Weight |
|-------------|--------|--------|--------|
| LB-220010 | 31 cm | 28 cm | 4,8 kg |



LB-220010

MATO Connect Bridge Beam

Ideal for landings and surface scaffolding.

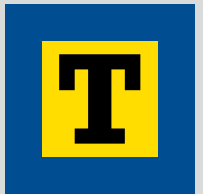

Large surfaces – quick installation

Compatible with the MATO 8 scaffolding system and all common modular systems.



AR ledger connection

- Made of steel

| Article no. | Width | Height | Weight |
|-------------|-------|--------|--------|
| LB-200042 | 15 cm | 26 cm | 1,4 kg |



LB-200042

AR shaft connection

- Made of steel

| Article no. | Length | Height | Weight |
|-------------|--------|--------|--------|
| LB-200043 | 38 cm | 50 cm | 7,6 kg |



LB-200043

MATO Connect **Bridge Beam**

The ingenious assembly principle with lowering and turning device.

Lowering and turning device

The lowering and turning device developed and patented by Tobler allows the bridge beams to be installed safely and quickly.



Height adjustable, rotating posts

- Made of steel
- With fast-running thread

| Article no. | Length | Height adjustment | Weight |
|-------------|--------|-------------------|--------|
| LB-210100 | 100 cm | 30 cm | 15,0kg |



LB-210100

Assembly aid, beam with steel wheels

- Made of steel

| Article no. | Length | Steel wheel dia. | Weight |
|-------------|--------|------------------|--------|
| LB-215050 | 103 cm | 10 cm | 18,8kg |



LB-215050



MATO Connect **Bridge Beam**

Quick and precise positioning.

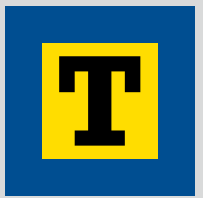

Hang – turn – position



Start by hanging up the next bridge beam.



The beam can then be safely rotated and prepared to receive the platforms.



Continue by laying down the platforms onto the bridge beam.



The last step consists in fastening the bridge beam in its new position using the platforms.

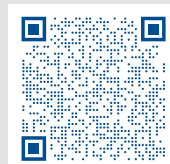

Assembly video

The quickest bridge beam installation



Tobler Mission statement

Efficiency. Flexibility. Safety.



Mission statement

Together we create solutions focused on our customers and their success.

As your reliable partner in all aspects of scaffolding and formwork assembly, we deliver tailor-made solutions, from planning and engineering to production.

As an innovative full-service provider, we think ahead and bring our philosophy of efficient, flexible, and safe construction into your industry.

With our products, you can count on outstanding functionality and the highest manufacturing quality.



Swiss Engineering.
Swiss Technology.

Your Tobler family

www.tobler-ag.com



Tobler Products

Enjoying industrialized construction.



MATO Scaffolding

| | | |
|--|---------------------|--------------------------------------|
| | MATO 1 | Facade scaffolding. |
| | MATO 2 | Facade scaffolding. |
| | MATO 3 | All-in-one scaffolding systems. |
| | MATO 8 | Modular scaffold system. |
| | MATO C | Compatible systems. |
| | MATO Connect | Bridging systems. |
| | MATO Pro | Roof scaffolding systems. |
| | MATO R | Rolling towers. |
| | MATO T | Scaffoldings for construction sites. |
| | MATO Z | Scaffolding accessories. |

Tobler Construction

| | | |
|--|------------------------|---------------------------------------|
| | Tobler Industry | Mounting safely. |
| | Tobler Trading | Buying at a reasonable price. |
| | Tobler Storage | Creating order more efficiently. |
| | Tobler Nature | Safe off-road. |
| | Tobler Special | Custom-made products made to measure. |

Tobler Formwork

| | | |
|--|-----------------------|------------------------|
| | Tobler Rex | Girder wall formworks. |
| | Tobler Varia | Special formworks. |
| | Tobler Desk | Slab tables. |
| | Tobler Flex | Props, beams, panels. |
| | Tobler Project | Special formworks. |
| | Tobler Top | Wall formwork. |
| | Tobler Manu | Handset formwork. |
| | Tobler Deck | Slab formwork. |
| | Tobler Tower | Heavy duty supports. |
| | Tobler Rent | Rental park. |
| | Tobler Care | Renovation. |

Tobler Occasions

| | | |
|--|-------------------------------------|------------------|
| | Tobler Occasions Formworking | Good, even used. |
| | Tobler Occasions Scaffolding | Worth the price. |



At home in Switzerland – anchored in Europe

We are constantly driving forward the internationalisation of our product range.



**Order
& advice**
sales@tobler-ag.com
+41 71 886 06 06

**Order
online**

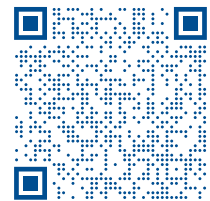

« With our lightweight bridge beam, work on the bridge progresses quickly, efficiently and safely. Unique: the patented assembly device for maximum time savings and safety during construction. »



Martin Tobler
CEO

